

# AIR-PURIFYING RESPIRATORS

---

FOR 742 SERIES TWIN CARTRIDGES



**SCOTT**<sup>®</sup>  
HEALTH & SAFETY

# XCEL HALF-FACEPIECE

RESPIRATORY PROTECTION THAT FITS EVERYONE

## Xcellent Comfort and Fit

Scott's Xcel half-facepiece is designed to fit every worker and every situation. It is available in four sizes, rather than the usual industry standard three, ensuring a perfect fit for almost everyone. Molded from a soft, yet durable thermoplastic elastomer (TPE) material, the Xcel just naturally fits better. It also has a wider face seal surface. The combination of supple material and increased sealing surface minimizes problems associated with fit testing while maximizing user comfort. The head cradle is easy to adjust and provides wider coverage over the crown of the head. Strap edges are rounded to eliminate irritation. Together, these features make the Xcel simple to don and doff, easy to fit and comfortable to wear. The Xcel offers superior protection that fits you, your job and the hazards of your industry.

## Xcellent Protection

The Xcel offers multi-level protection. In addition to better fit around the face surface, the versatile Xcel half-mask features a unique "fold" over the bridge of the nose. This convolution acts as a shock absorber for stress generated through normal facial movement. By absorbing stress associated with movement, the mask remains more securely in place. The possibility of seal leak, especially when the wearer is talking, is significantly decreased.



The Xcel is also engineered to accept Scott's full line of easy-breathing 742 Series twin cartridges. These high performance cartridges are positioned out of the line of vision to give the wearer an unobstructed view of the work area.



# E

## YONE AND EVERYWHERE



### Xcellent Wearability

The Xcel's innovative harness design prevents mask interference from glasses, goggles, head gear or ear protection. Convenient one-step adjustment and a unique D-ring and clip help provide a snug fit against the face of any user. Everything is designed to be simple to adjust and fasten even with gloved hands.

### Xcellent Voice and Sound Transmission

The optional "voicemitter" is another new feature of the Xcel half-facepiece. This technically advanced transmitter dramatically improves voice clarity. Enhanced personal communication helps reduce the possibility of mistakes in the workplace and improves worker effectiveness and safety.

### Xcellent Value

The Xcel gives safety directors and industrial hygienists the opportunity to provide workers with a highly effective, high performance half-facepiece respirator. No other respiratory protection product on the market comes close to matching the Xcel for enhanced comfort, fit, protection and overall value.

Try the Xcel, and breathe a little easier for many reasons. You'll see why product excellence is Scott Health and Safety's trademark and your assurance of superior performance.

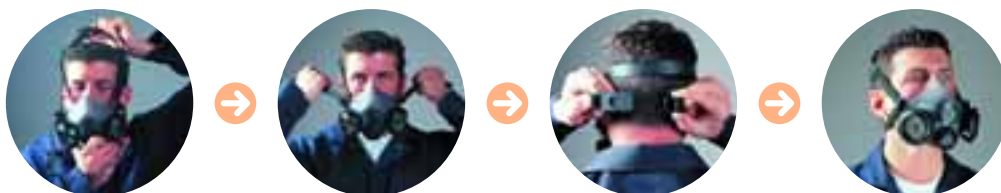

### Approvals

- NIOSH approved 42CFR84 for use with a variety of cartridges in atmospheres that are not Immediately Dangerous to Life and Health (non-IDLH) environments

Part Number	Box of 20 Pieces	Description
Single Facepiece		XCEL Half-facepiece
7421-111	7421-211	Facepiece Assembly, Small
7421-112	7421-212	Facepiece Assembly, Small/Medium
7421-113	7421-213	Facepiece Assembly, Medium/Large
7421-114	7421-214	Facepiece Assembly, Large
7421-111V	7421-211V	Facepiece Assembly, Small w/Voicemitter
7421-112V	7421-212V	Facepiece Assembly, Small/Medium w/Voicemitter
7421-113V	7421-213V	Facepiece Assembly, Medium/Large w/Voicemitter
7421-114V	7421-214V	Facepiece Assembly, Large w/Voicemitter

### XCELLENCE AT ITS BEST

The Xcel half-facepiece from Scott Health and Safety is one of the most innovative, technologically advanced half-mask respirators introduced in the last decade. The new technologies incorporated into the Xcel make it the ideal respirator choice for virtually any industrial, agricultural or manufacturing application. The Xcel features a complete line of cartridges and filters designed to protect against gases, vapors, fumes, particulates and any combination of these noxious airborne elements. The Xcel's superior performance is your assurance of the highest level of half-mask protection from respiratory hazards in today's workplace.



# PROMASK™ 25 FULL-F

RESPIRATORY PROTECTION FOR NON-IDLH

## Professional Fit and Comfort

Scott's Promask 25 full-facepiece is lightweight, balanced and ergonomically designed for use in virtually any industrial or manufacturing environment. Engineered of halo-butyl elastomer, this respirator offers unmatched resistance to chemicals, ozone aging and high temperatures. A uniquely contoured wider sealing edge provides a superior fit; while a sweat port in the chin pocket provides added comfort during extended wear times. The Promask 25 is available in two sizes with an infinitely adjustable 5-point head harness to assure a perfect fit on any face. The head cradle is easy to adjust and provides wider coverage over the crown of the head. Strap edges are rounded to prevent irritation. Together, these features make the Promask 25 easy to fit and comfortable to wear.

## Professional Protection

The Promask 25 offers multi-level protection. In addition to a superior fit around the surface of face, the versatile Promask 25 features a wider lens for an extended field of vision. A non-allergenic, clear silicone nose cup offers a feeling of openness without blocking one's vision. This nose cup also helps to alleviate the stress associated with normal facial movements, thus remaining more securely in place. The possibility of seal leak, especially when the user is talking, is significantly decreased.

## Professional Wear

Easy to don and doff, the Promask's inventive harness design also eliminates respirator interference from headgear or ear protection. And, with optimum usage in mind, the Promask 25 allows for simple disinfection, decontamination and maintenance. The Promask 25 is designed to be the single solution for respiratory protection.

## Professional Communications

The Promask 25 also features a built-in speech diaphragm for optimal personal communication. The speech diaphragm helps to improve voice clarity. Enhanced personal communication helps reduce the possibility of mistakes in the workplace and improves worker effectiveness and safety.

# A CEPIECE

## ENVIRONMENTS



### Professional Performance

The Promask offers safety directors and industrial hygienists the opportunity to provide workers with a highly effective, high performance full-facepiece respirator. No other full-facepiece on the market comes close to matching the Promask for enhanced comfort, fit, protection and overall value. Scott's Promask 25, the respiratory solution that fits you, the job, and the hazards you face.

### Approvals

- NIOSH approved to 42 CFR Part 84 for use with a variety of cartridges from the 742 Series Twin Cartridges for use in atmospheres that are not Immediately Dangerous to Life and Health (non-IDLH) environments

### Specifications

Weight	1.2 lbs. (0.55 kg), Mask only
Nosecup	Silicone
Mask body	Halo-butyl blended elastomer
Seal	Halo-butyl blended elastomer

#### Promask 25 Ordering Information

Part Number	Description
013024	Promask 25, M/L, Rubber Harness, Polycarbonate Lens
013063	Promask 25, M/L, Rubber Harness, Hardcoat Lens
013027	Promask 25, S, Rubber Harness, Polycarbonate Lens
013067	Promask 25, S, Rubber Harness, Hardcoat Lens
013023	Promask 25, M/L, Textile Harness, Polycarbonate Lens
013028	Promask 25, S, Textile Harness, Polycarbonate Lens
013064	Promask 25, M/L, Textile Harness, Hardcoat Lens
013068	Promask 25, S, Textile Harness, Hardcoat Lens

#### Promask 25 Accessories Ordering Information

Part Number	Description
012698	Lens Cover, Package of 10
012798	Spectacle Kit

### THE PROFESSIONAL CHOICE

Scott Health & Safety's Promask 25 offers safety professionals the latest in full-facepiece respiratory protection. The Promask 25 is the ideal choice for most industrial, agricultural or manufacturing applications requiring full-facepiece protection. The Promask is compatible with Scott's complete line of 742 Series Twin Cartridges and filters designed to protect against gases, vapors, fumes, particulates and any combination of these noxious airborne elements. The Promask's superior performance is your assurance of the highest level of full-facepiece protection from the infinite respiratory hazards in today's workplace.

# 742 TWIN SERIES

A FULL LINE OF EASY-BREATHING CARTRIDGES



## 742 Series Twin Cartridges

Easy breathing 742 Series twin cartridges developed for Scott's Xcel, Promask 25, AV-2000 and AV-3000 facepieces, minimize equipment inventories, while providing maximum protection in non-IDLH industrial situations. Scott provides a full range of NIOSH 42 CFR 84 approved filters, chemical cartridges for gases and vapors, and cartridges for combination particulate/gas-vapor. A multipurpose cartridge (MPC) protects against multi-hazard vapors and gases, and allows freedom to move within areas containing multiple hazard exposure. These cartridges are also available with N95, R95 or P100 filters for use in a broader range of hazardous environments. A simple quarter turn of the cartridge provides a secure fit to any Scott facepiece.



Cartridges Packaged By The Pair	
Part Number	Description
7422-WA1	Acid Gas
7422-WB1	Acid Gas with P100
7422-GA1	Ammonia/Methylamine
7422-GB1	Ammonia/Methylamine with P100
7422-IA1	Formaldehyde
7422-IB1	Formaldehyde with P100
7422-BA1	Organic Vapor
7422-BB1	Organic Vapor with P100
7422-YC1	Organic Vapor/Acid Gas
7422-YD1	Organic Vapor/Acid Gas with P100
7422-ZA1	Mercury Vapor/Chlorine (w/EOS Life Indicator)
7422-ZB1	Mercury Vapor/Chlorine Gas with P100 (w/EOS Life Indicator)
7422-SC1	Multi-purpose
7422-SD1	Multi-purpose with P100
7422-FP1	P100 Filter
7422-PD1	Triethylenediamine (TEDA) with P100
7422-FN2	N95 Filter (25 pair)
7422-FR5	R95 Filter (50 pair)
7422-FE4	Enclosure Cover & Retainer (5 Pair Per Box)

# FIT-TESTING EQUIPMENT

FOR QUANTITATIVE AND QUALITATIVE FIT-TESTING

## Quantitative Fit-Testing Equipment

- Probed fit test adapters for annual quantitative fit-testing
- Allows the wearer to be tested in their own facepiece

\*Requires quarter turn adapter (p/n 805622-01) to be installed

(i) Also requires use of 742 Series P100 cartridges that are purchased separately

Quantitative Fit Test Ordering Information		
Facepiece	Fit-Testing Device	Probed Adapter
Xcel, Promask25, Av-2000*, AV-3000*	Portacount	7422-FT(i)

## Bitrex® Qualitative Fit Test Kit

- Simple and Easy to Perform
- Ensures Proper Respirator Fit
- Uses Harmless Bitrex Solution
- Ideal for Tight Fitting Half and Full Facepieces
- Meets All Performance Criteria for Current OSHA Standards

Qualitative Fit Test Ordering Information	
Part Number	Description
2017070	Bitrex Qualitative Fit Test Kit (Complete)

# CLEANER/DISINFECTANT

MAINTENANCE THAT IS SAFE FOR YOU AND YOUR EQUIPMENT

## Multi-Wash™ Mini

To clean and disinfect the Promask 25, Xcel, AV-2000 or AV-3000, use Multi-Wash Mini cleaner/disinfectant. This safe premeasured bactericidal, fungicidal, virucidal agent eliminates the need to mix and measure.



Multi-Wash Mini Ordering Information	
Part Number	Description
1001068	16-Ounce Bottle with Spray Attachment
10010304	One Gallon Bottle with Spray Attachment

**WARNING**

Improper use of these respirators may result in personal injury or death. Improper use includes, but is not limited to, use without adequate training, disregard of the warnings and instructions, and failure to inspect and maintain these respirators.

These respirators are intended to be used only in conjunction with an organized written respiratory protection program, which complies with the requirements of OSHA Safety and Health Standard 29 CFR 1910 Paragraph 134, available from the U.S. Department of Labor, Occupational Safety and Health Administration, or other pertinent nationally recognized standards.

These respirators are not intended to be used in atmospheres which are, or may become, immediately dangerous to life and health (IDLH) or in atmospheres where the identity and/or the concentration of the contaminate is unknown.

*Monroe Corporate Center • P.O. Box 569 • Monroe, NC 28111  
Telephone: 800.247.7257 • Facsimile: 704.291.8330  
www.scotthealthsafety.com • sh-sale@tycoint.com*

*Scott Health & Safety is a global business unit of Tyco Fire & Security that supplies a variety of industries through manufacturing facilities located in the United States, United Kingdom, Asia, Finland, and Australia.*